

Add Health Questionnaire App to you Phone/Table

iPhone/iPad (Using Safari)

- 1) Open up Safari
- 2) Go to <https://plusportals.com/sjbdhs>
- 3) On the bottom of the page click the **Share Icon**.

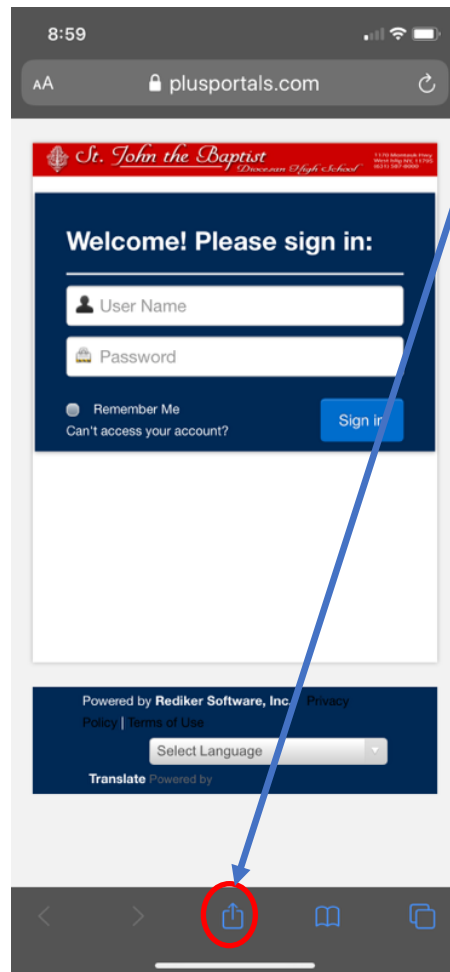

4) You can add it as a Favorite, or **Add to Home Screen** as an App

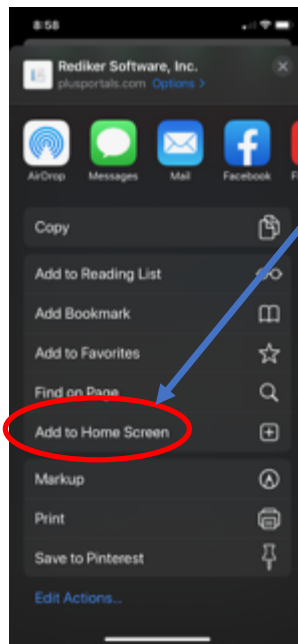

5) Click **Add** to add it to your home screen

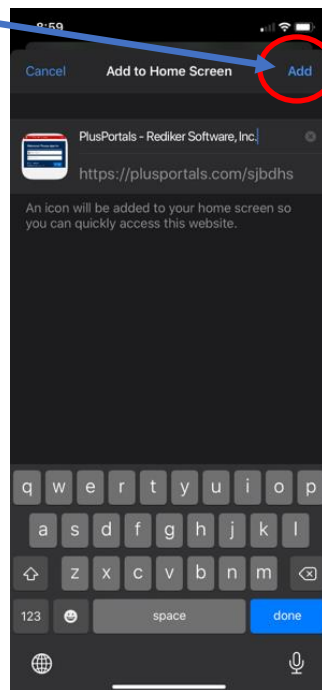

Android Phone (Using Google Chrome)

- 1) Open up Chrome
- 2) Go to <https://plusportals.com/sjbdhs>
- 3) Click the 3 dots at the top right

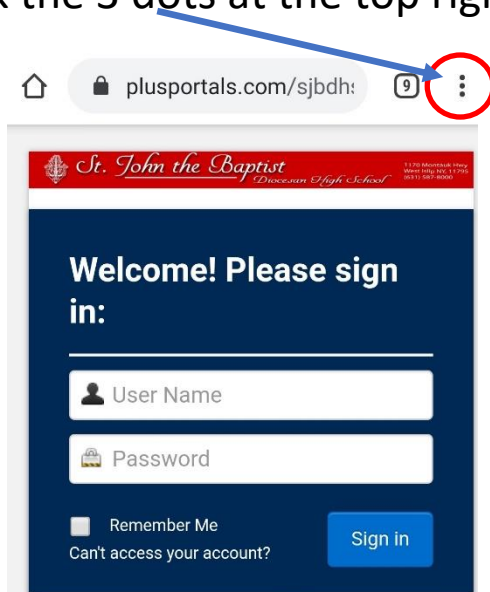

- 4) You can add it as a Favorite, or **Add to Home Screen** as an App

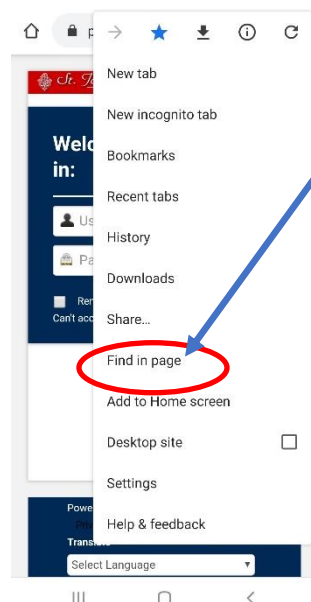

5) Click **Add** to add it to your home screen

